

$V=8$
 $F=6$
 $E=12$

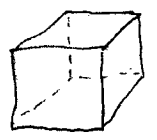

$V+F-E=2$
 $4+4-6=2$



$F=6$
 $V=8$
 $E=12$



$F=4$
 $V=4$
 $E=6$ ✓



$F=5$
 $V=5$
 $E=8$

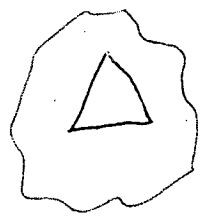

$F=2$ ✓
 $V=3$
 $E=3$



$V=E$
 $F=2$

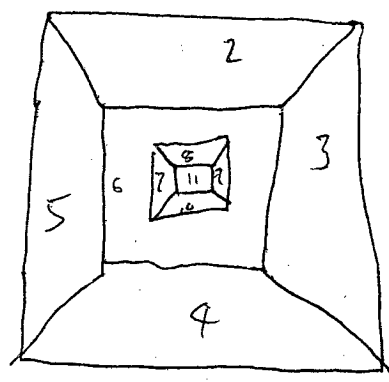
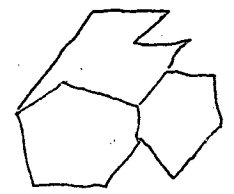

$V=16$
 $F=11$
 $E=24$

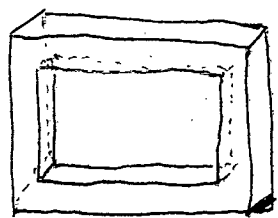

$F=10$
 $V=16$
 $E=24$

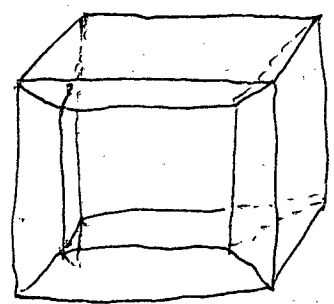

$V=12$
 $F=12$
 $E=24$

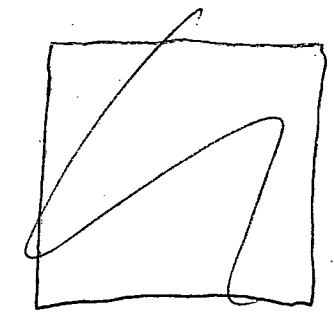
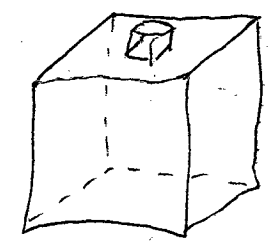

$V=16$
 $F=10$
 $E=24$ ✓

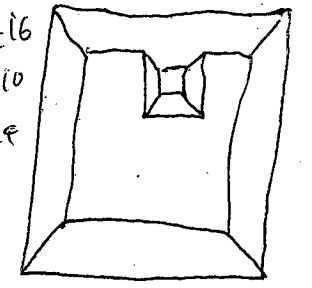

1993 Payments

Date	Tax point	Description	Amount inc. VAT	Amount ex VAT	Travel Hotels Meals	Materials Stationery	Subs. Fees Services	Tangible Assets	Other	VAT	VAT Rate	Receipt nos.	Notes
23/06/95	03/06/95	stationery	40.13	34.15		34.15					5.98 s	R845	
05/06/95	05/06/95	stationery	12.50	10.64		10.64					1.86 s	R839	
06/06/95	06/06/95	electronic mail chs (April)	11.13	9.47			9.47				1.66 s	R834	
		Brenda's counselling sessions required for cert. + travel	60.00	60.00	6.60		60.00				0.00		2 sessions
			6.60	6.60							0.00		
09/06/95	09/06/95	bank charges	30.54	30.54			30.54				0.00		
23/06/95	12/06/95	gas (20%)	11.66	10.80			10.80				0.86 f	R853	
12/06/95	12/06/95	photocopying	13.94	11.86		11.86					2.08 s	R841	
12/06/95	12/06/95	photocopying	3.20	2.72		2.72					0.48 s	R840	
13/06/95	13/06/95	courier charges	34.49	29.35			29.35				5.14 s	R842	
14/06/95	14/06/95	stationery	0.75	0.64		0.64					0.11 s	R837	
14/06/95	14/06/95	photocopying	0.60	0.51		0.51					0.09 s	R843	
19/06/95	19/06/95	fares to Camberley	9.60	9.60	9.60						0.00	R845	
19/06/95	19/06/95	coffee on visit to EDS	0.90	0.90	0.90						0.00		
20/06/95	20/06/95	FACS meeting	54.70	54.70	54.70						0.00		
23/06/95	19/06/95	telephone) 50%	62.48	53.17			53.17				9.31 s	R848	
23/06/95	08/06/95	telephone)	26.75	22.77			22.77				3.98 s	R849	
28/07/95	26/06/95	electricity (40% of bill)	33.51	31.03			31.03				2.48 f	R892	
30/06/95	30/06/95	Expenses on EC visit Brussels	1,015.49	988.67	65.20	27.72	160.40	0.00	144.61		26.82		
12/07/95	12/07/95	word processor	299.00	254.47				254.47			44.53 s	R911	
12/07/95	12/07/95	computer stationery	17.98	15.30		15.30					2.68 s	R911	
12/07/95	12/07/95	subscription to Br. Ass. Cou.	21.00	21.00			21.00				0.00		
14/07/95	14/07/95	Expenses on visit to EC	948.56	948.56	945.06	0.00	3.50	0.00	0.00		0.00		
		Brenda's counselling sessions required for cert. + travel	30.00	30.00			30.00				0.00		
			3.30	3.30	3.30						0.00		
20/07/95	20/07/95	fares to meeting	3.30	3.30	3.30						0.00		
21/07/95	21/07/95	photocopying	0.60	0.51		0.51					0.09 s	R889	
23/07/95	23/07/95	photocopying	8.19	6.97		6.97					1.22 s	R890	
24/07/95	24/07/95	postage	0.48	0.48			0.48				0.00		
25/07/95	25/07/95	postage	3.42	3.42			3.42				0.00	R891	
06/09/95	27/07/95	fares for week	23.30	23.30	23.30						0.00		
28/07/95	28/07/95	electronic mail charges	12.13	10.32			10.32				1.81 s	R892	
29/07/95	29/07/95	postage	0.77	0.77		0.77					0.00		
02/08/95	02/08/95	EC visit to Brussels	468.33	468.33	466.58	0.00	1.75	0.00	0.00		0.00		
		Brenda's counselling sessions required for cert. + travel	30.00	30.00			30.00				0.00		
			3.30	3.30	3.30						0.00		
		B's phone calls to clients	1.20	1.20			1.20				0.00		
		B's phone calls	7.50	7.50			7.50				0.00		
12/08/95	12/08/95	EC visit to Brussels	578.84	578.84	578.84	0.00	0.00	0.00	0.00		0.00		
23/08/95	23/08/95	FME meeting in Copenhagen	424.48	424.48	424.48	0.00	0.00	0.00	0.00		0.00		
26/09/95	23/08/95	Audit fee	772.21	657.20			657.20				115.01 s	R918	
30/08/95	30/08/95	photocopying	0.08	0.08		0.08					0.00	R916	
31/08/95	31/08/95	postage	2.29	2.29		2.29					0.00		